

LAKE ALICE DAM BREACH REMEDIATION PLAN

FOR
CITY OF CUMMING

LEGEND

ASP	ASPHALT PAVING	JIB	JUNCTION BOX
BC	BACK OF CURB	LL	LAND LOT
BM	BENCHMARK	LLI	LAND LOT LINE
BL	BUILDING LINE	LP	LIGHT POLE
CB	CAST IRON PIPE	NP	NOW OR FORMERLY
CD	CATCH BASIN	PC	POINT OF CURVATURE
CL	CENTERLINE	PV	POINT OF TANGENCY
CLF	CHAIN LINK FENCE	POC	POINT ON CURVE
CH	CHORD	POT	POINT ON TANGENT
CM	CONCRETE	POL	POINT ON LINE
CM	CONCRETE MONUMENT	PVC	POLYVINYLCHLORIDE
CMP	CORRUGATED METAL PIPE	PW	POWER LINE
DD	DIVERSION DITCH	PP	POWER POLE
DD	DOWNDRAIN	PTB	POWER TRANSFORMER BOX
DE	DRAINAGE EASEMENT	PL	PROPOSED CONTOUR
DS	DRAINAGE SWALE	R	RADIUS
DI	DROP INLET	RCP	REINFORCED CONCRETE PIPE
DIP	DUCTILE IRON PIPE	RW	RIGHT OF WAY
EL	ELEVATION	SS	SANITARY SEWER
EOP	EDGE OF PAVEMENT	SSS	SANITARY SEWER EASEMENT
ES	EMERGENCY SPILLWAY	SB	SETBACK
FF	FINISHED FLOOR ELEVATION	SD	SLOPE DOWN (1/4'FOOT)
FH	FIRE HYDRANT	TL	TELEPHONE LINE
FES	FLARED END SECTION	TP	TELEPHONE POLE
G	GAS LINE	TM	TEMPORARY BENCHMARK
GP	GUY POLE	W	WATER LINE
HW	HEADWALL	WM	WATER METER
IE	INVERT ELEVATION	WW	WATERVALVE
INT	INTERSECTION	WI	WEIR INLET
IPF	IRON PIN FOUND		
IPS	IRON PIN SET		

Project Narrative:
 Project Name: LAKE ALICE DAM BREACH REMEDIATION PLAN
 Site Address / Location: AT SANDERS RD AT LAKE LANIER UPSTREAM TO MARKET PLACE BLVD
 Tax Map Number: C29-012,C38-013,C39-001 District: 2nd Land Lot(s): 78 & 139

Item A: Property Owner: CITY OF CUMMING/MASHBURN
 Address: 100 N. MAIN ST- CUMMING GA 30004
 Phone Number: (678)773-1535

Item B: Persons to be contacted by county in case of development or construction problems:
 Name: DANNY BENNETT Title:PROJECT ENGINEER Phone # (678)773-1535 (24 HRS.)
 Address: SAME AS ABOVE
 Alternate Name: Title: Phone #

Item C: Proposed Use of Land: N/A
 Size of disturbed work area: 1.5 ACRES Total site area: N/A ACRES
 Cubic Yards of Soil to be moved: N/A New location of excess soil: N/A

Item D: See Construction Schedule, this sht

Item E: Zoning of Property: Ag/cbd Zoning of Adjoining Properties: Ag/CBD

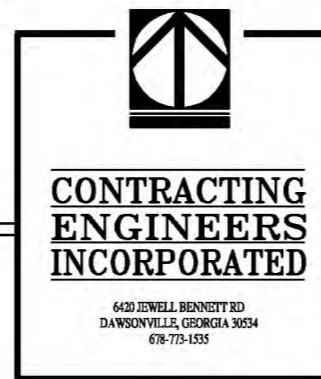

SHEET #	TITLE
1.0	COVER SHEET
2.1	OWNER INFORMATION
2.2	STATE WATERS PRE-BREACH
2.3	STATE WATERS POST BREACH
2.4	DAM TOPO PRE/POST BREACH
3.1	INITIAL PHASE
1-3	WEIR INSTALLATION/LAKE BED STABILIZATION(BY NEWFIELDS)
3.3	INTERMEDIATE PHASE-SANDERS RD STAGING
3.4	CONSTRUCTION PHASE-SANDERS RD STAGING
3.5	FINAL PHASE-SANDERS RD STAGING
4.1	EROSION DETAILS
4.2	ROCK DAM DETAILS
4.3	DOT TEMP DIVERSION DETAIL
4.4	DOUBLE 8' X 8' BOX CULVERT BARREL DETAIL
4.5	DOUBLE 8' X 8' BOX CULVERT WINGWALLS & PARAPET DETAIL

MAINTENANCE SCHEDULE
 FOR A PERIOD OF 18 MONTHS FROM DATE OF BEGINNING INITIAL PHASE

- MONITOR ON A QUARTERLY BASIS THE "LAKE BED CHANNELS" AND RESEED AND HANDWORK AREAS AS NECESSARY TO INSURE REVEGETATION.
- MONITOR ON A BI-QUARTERLY BASIS LITTLE RIDGE CREEK AND REMOVE (AS PER PERMIT DRAWINGS) ANY SEDIMENTS DEPOSITED AS A RESULT OF EROSION FROM THE "LAKE BED CHANNELS".
- MONITOR ON A QUARTERLY BASIS ALL DISTURBED AREAS CAUSED BY CONSTRUCTION AND RESEED AS NECESSARY TO INSURE PERMANENT VEGETATION.
- AFTER ALL AREAS AFFECTED BY THE BREACH ARE PERMANENTLY STABILIZED, PROCEED TO SHEET 3.5 AND REMOVE ALL INSTALLED BMP'S EXCEPT AS NOTED IN THE EVENT ALL AREAS ARE NOT STABILIZED TO THE SATISFACTION OF ALL INVOLVED JURISDICTIONAL AUTHORITIES, THE PLANS SHALL BE MODIFIED AS NECESSARY TO ACHIEVE FINAL STABILIZATION AND RE-SUBMITTED FOR APPROVAL AND IMPLEMENTATION.

NewFields

CONTACT INFO:
 Brian Wellington, Ph.D., P.E.
 NewFields Companies LLC
 1349 W. Peachtree St. Suite 2000
 Atlanta, GA 30309
 Ph: (404)969-0987
 Fax: (404)969-0988
 www.newfields.com



CONTACT INFO:
 D.M. Bennett, P.E.
 Contracting Engineers Inc.
 6420 Jewell Bennett Rd
 Dawsonville, GA 30534
 Ph: (678)773-1535
 Fax: (678)807-2698

ACTIVITY	WEEKS	1	2	3	4	5	6	7	8	9	10	11	12	13	14	15	16	17	18	19	20	21	22	23	24
CLEARING AND GRUBBING	N/A																								
EROSION CONTROL IMPLEMENTATION																									
EROSION CONTROL MAINTENANCE																									
CUT & FILL																									
GRASSING (LIMIT EXP TO 7 DAYS)																									
UTILITY INSTALLATION																									
CONSTRUCTION																									
FINISH GRADING																									
FINAL STABILIZATION																									

SOILS INFORMATION					
SOIL SYMBOL	NAME	SLOPE %	ERO FACTOR	LIMITATION	PERMEABILITY
N/A	CUT & FILL	10-20	N/A	N/A	N/A

"I CERTIFY THAT A QUALIFIED PERSON FROM CONTRACTING ENGINEERS, EITHER THE PLAN PREPARER OR THE DESIGNEE, HAS VISITED THE SUBJECT SITE PRIOR TO THE CREATION OF THIS PLAN."

D.M. Bennett

D.M. BENNETT, P.E. 19,305- LEVEL II CERTIFIED DESIGN PROFESSIONAL #28,293

PROGRESS PRINT 08 JAN 14
 THIS DOCUMENT SUBJECT TO FINAL DESIGN BY ALL ENGINEERS OF RECORD AND PERMITTING BY ALL GOVERNING AUTHORITIES



IF YOU DIG GEORGIA...
 CALL US FIRST!
 1-800-232-7411
 (770) 623-4344
 (METRO ATLANTA ONLY)
 UTILITIES PROTECTION CENTER
 IT'S THE LAW

CAUTION
 THE UTILITIES SHOWN ARE SHOWN FOR THE CONTRACTOR'S CONVENIENCE ONLY. THERE MAY BE OTHER UTILITIES NOT SHOWN ON THESE PLANS. THE PREPARER ASSUMES NO RESPONSIBILITY FOR THE LOCATIONS SHOWN AND IT SHALL BE THE CONTRACTOR'S RESPONSIBILITY TO VERIFY THE LOCATIONS OF ALL UTILITIES WITHIN THE LIMITS OF THE WORK. ALL DAMAGE MADE TO EXISTING UTILITIES BY THE CONTRACTOR SHALL BE THE SOLE RESPONSIBILITY OF THE CONTRACTOR.



CONTRACTING ENGINEERS INCORPORATED
 6420 JEWELL BENNETT RD
 DAWSONVILLE GA 30534
 (678) 773-1535

LAKE ALICE DAM BREACH REMEDIATION

* COVER

REVISIONS:

Date: AUG 28, 2013
 Scale: 1"= NTS
 JOB NO.: base@SANDERS.CUMMING
 Sheet: 1 of 10 sheets

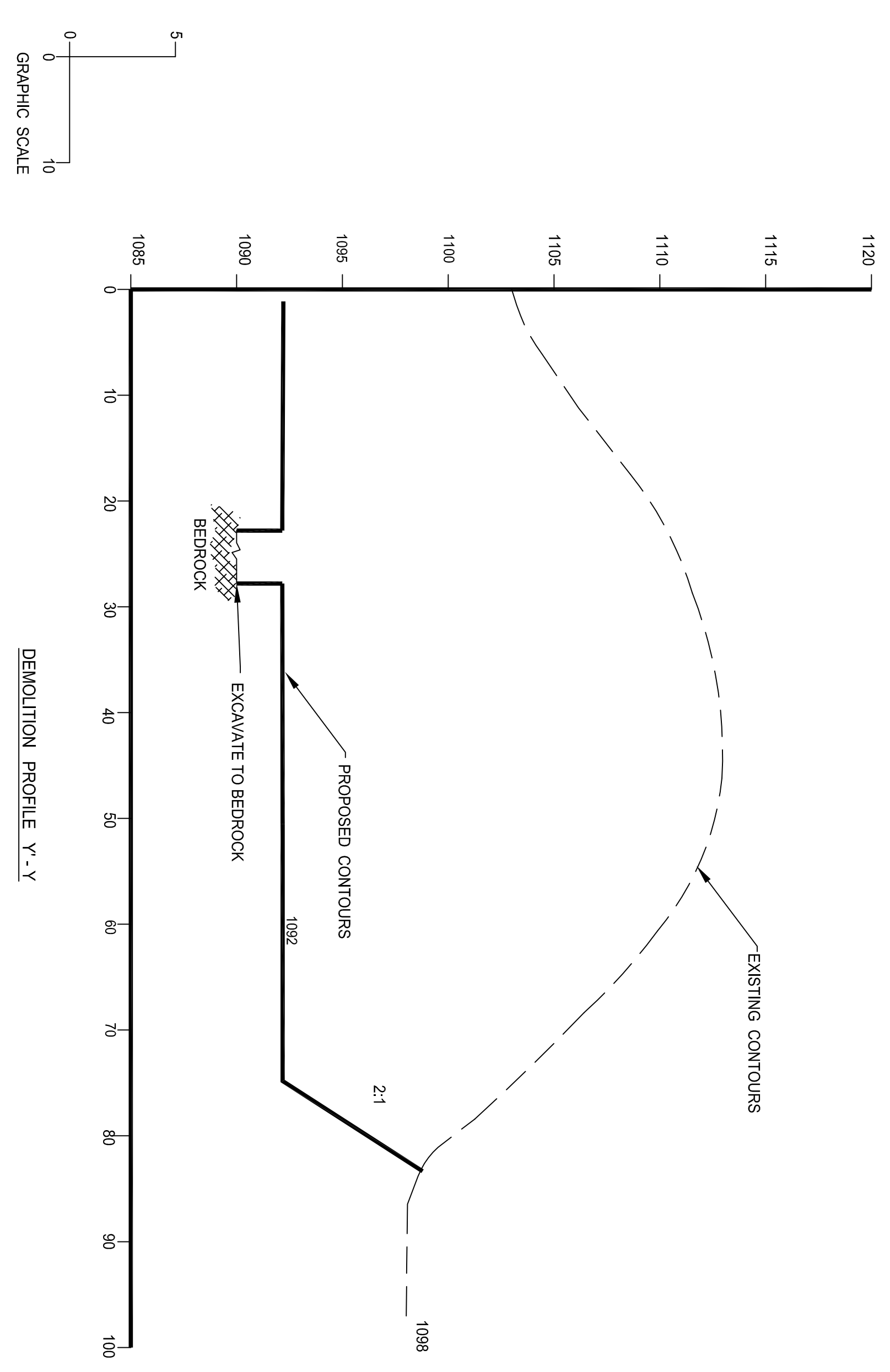
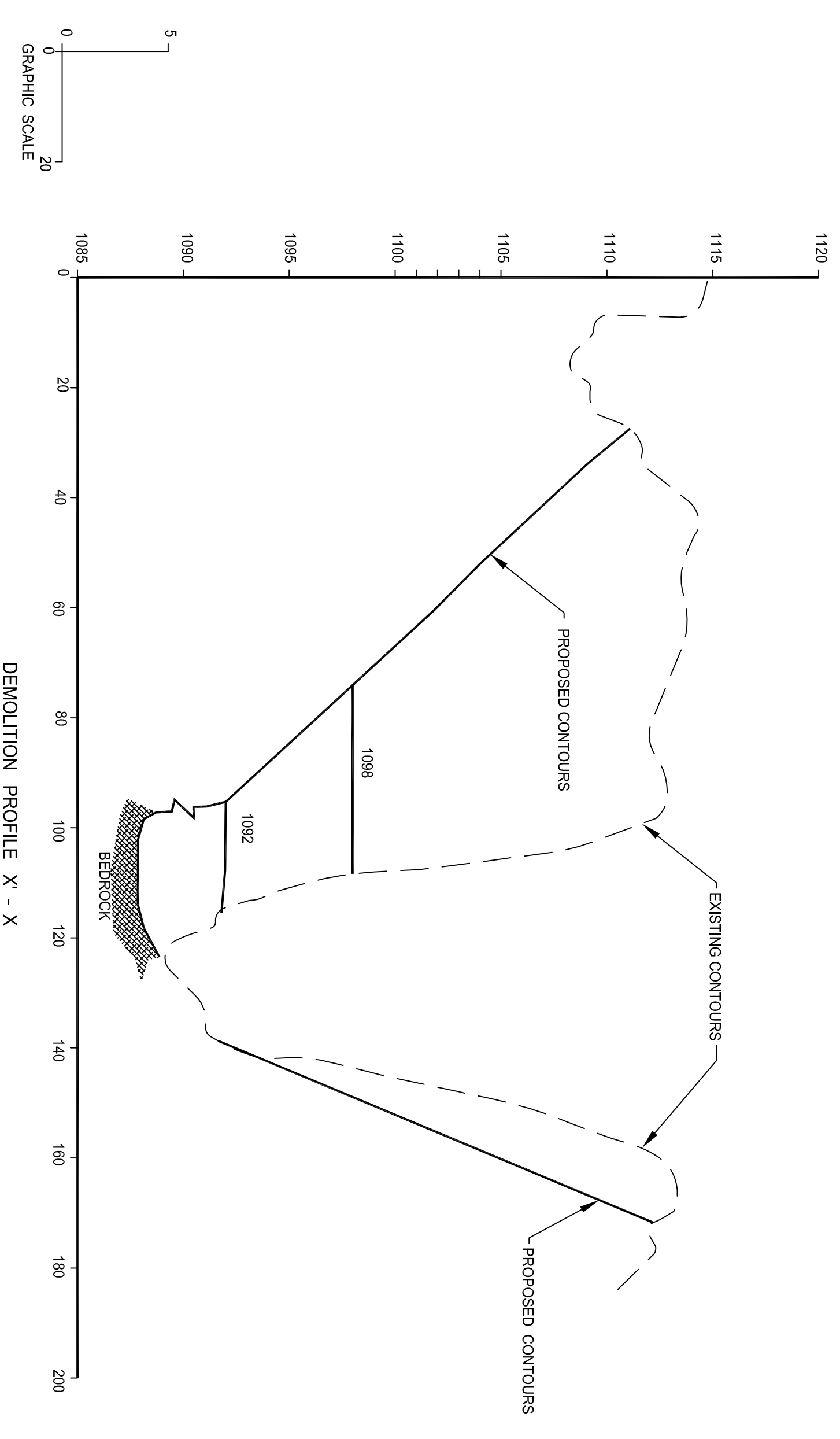
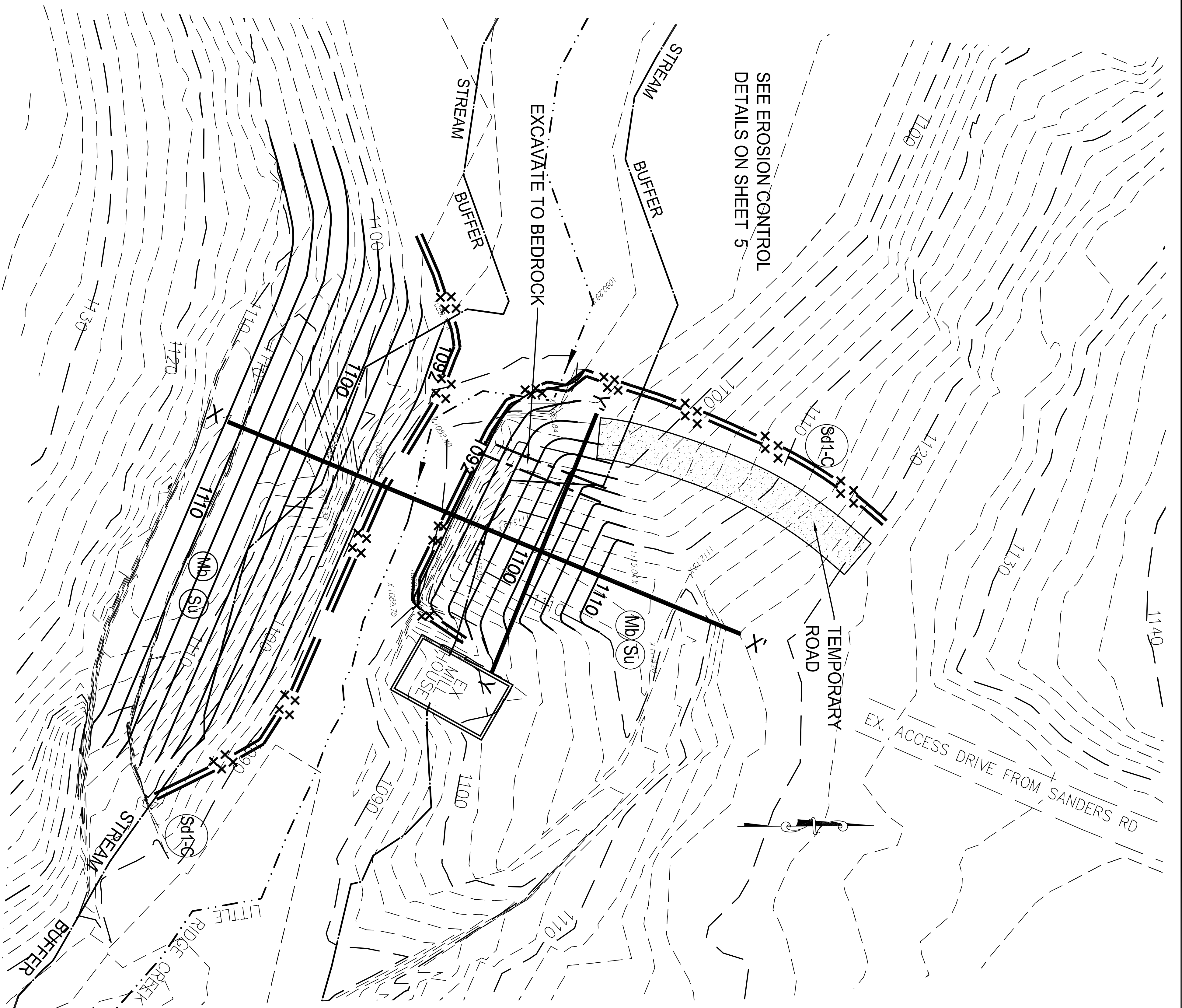

- DAM DEMOLITION PLAN NOTES**
- SOILS EXCAVATED FROM THE DAM WILL BE USED TO BUILD THE TEMPORARY ROAD INTO THE LAKE BED.
 - ADDITIONAL EXCAVATED MATERIAL WILL BE STOCKPILED ON THE MASHBURN PROPERTY OUTSIDE OF THE LAKE BED.
 - THE STOCKPILE WILL BE PROTECTED FROM EROSION BY THE USE OF STRAW MULCH, SEEDING AND HAY BALES WILL BE INSTALLED AROUND ITS PERIMETER.
 - ALL EXPOSED SLOPES WILL BE PROTECTED USING EROSION CONTROL MATS AND SEEDS.
 - IT IS ESTIMATED THAT THE DEMOLITION OF THE DAM WILL BE PERFORMED WITHIN 5 DAYS.

<p>TWO MIDTOWN PLAZA, SUITE 2000 1349 WEST PEACHTREE STREET ATLANTA, GEORGIA 30308</p>		<p>PROJECT NO. LAKE ALICE DAM BREACH REMEDIATION</p> <p>DATE: APRIL 2014</p>																															
<p>DATE: _____ BY: _____</p>		<p>SCALE: AS SHOWN</p>																															
<p>REVISIONS</p> <table border="1"> <thead> <tr> <th>DATE</th> <th>BY</th> <th>DESCRIPTION</th> </tr> </thead> <tbody> <tr> <td> </td> <td> </td> <td> </td> </tr> <tr> <td> </td> <td> </td> <td> </td> </tr> <tr> <td> </td> <td> </td> <td> </td> </tr> <tr> <td> </td> <td> </td> <td> </td> </tr> <tr> <td> </td> <td> </td> <td> </td> </tr> <tr> <td> </td> <td> </td> <td> </td> </tr> <tr> <td> </td> <td> </td> <td> </td> </tr> <tr> <td> </td> <td> </td> <td> </td> </tr> <tr> <td> </td> <td> </td> <td> </td> </tr> </tbody> </table>		DATE	BY	DESCRIPTION																												<p>PHASE 1 WEIR INSTALLATION AND LAKE BED STABILIZATION</p> <p>DRAWN BY: LCH</p> <p>CHECKED BY: BW</p> <p>CAD FILE: LakeAlice\LakeAlice13.dwg</p> <p>5/12/14</p>	
DATE	BY	DESCRIPTION																															
<p>DAM DEMOLITION PLAN</p>		<p>DRAWING NO. 4</p> <p>SHEET 4 OF 5</p>																															

BLANKET AND MATTING CROSS-SECTIONS
UPSTREAM TERMINAL

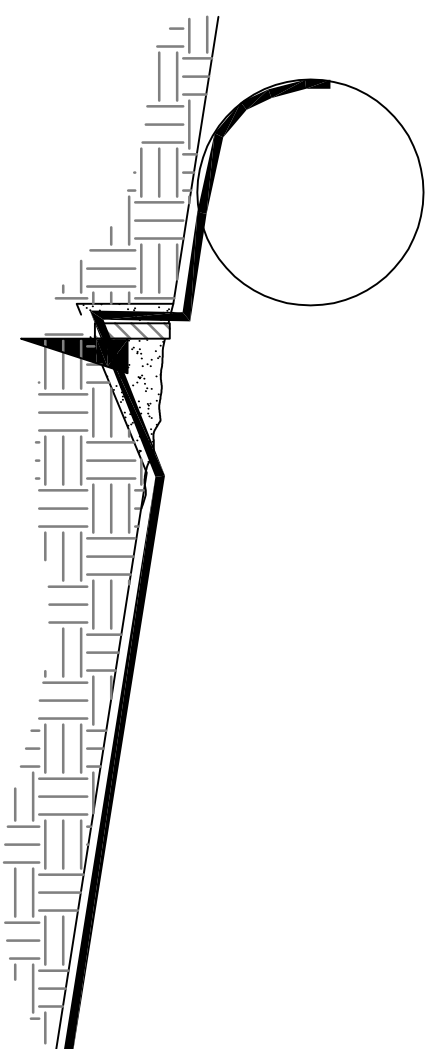
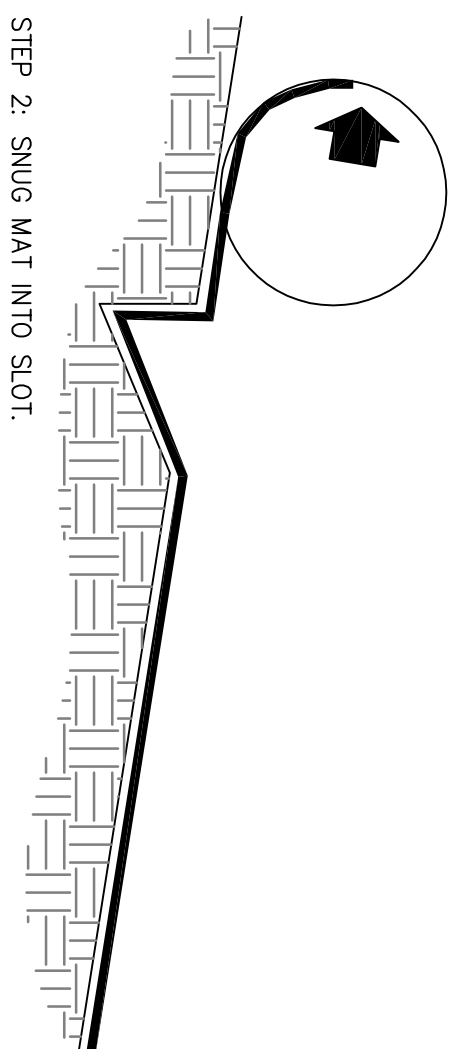
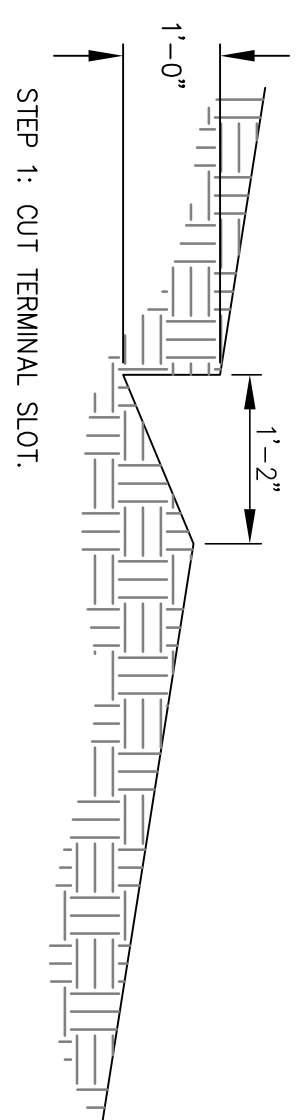

- A. STAKE MAT INTO SLOT.
- B. USE 1" X 3" PRESSURE TREATED BOARD TO SPACE MAT AGAINST VERTICAL SLOT.
- C. BACKFILL AND COMPACT.

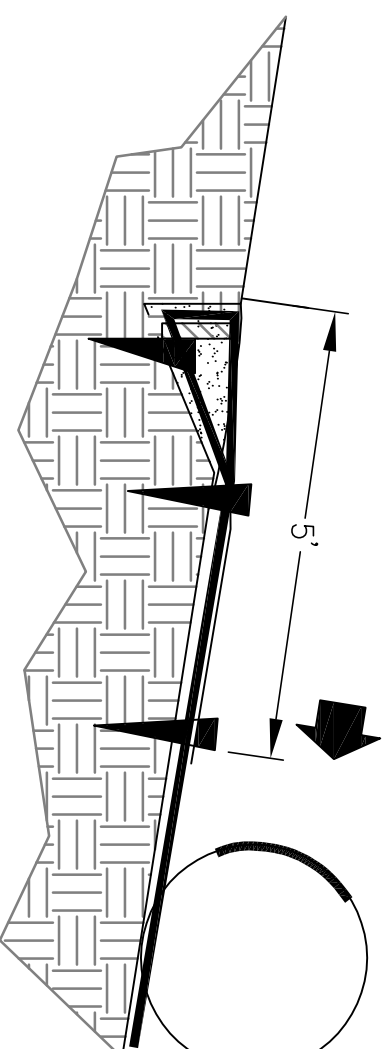

- A. REVERSE MAT ROLL DIRECTION TO OVERLAY CHECK LOT.
- B. STAKE MAT TO ANCHOR TERMINAL.

Mb Typical Installation Guidelines For Rolled Erosion Control Products (RECP)

TYPE "C" SILT FENCE PER SECTION 171 - TEMPORARY SILT FENCE, OF THE GEORGIA D.O.T. STANDARD SPECIFICATIONS

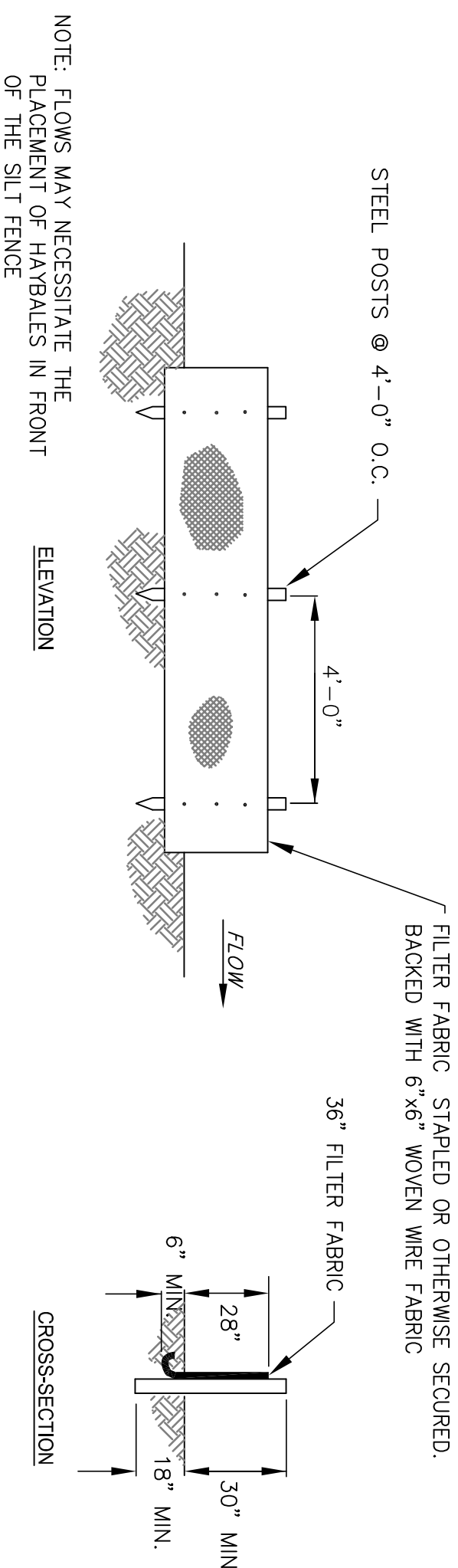

Sd1 Sediment Barrier - TYPE "C"

NTS.

NOTES

- 1.) FLOWS MAY NECESSITATE THE PLACEMENT OF HAYBALES IN FRONT OF THE SILT FENCE.
- 2.) TYPE "C" SILT FENCE PER SECTION 171-TEMPORARY SILT FENCE, OF THE GEORGIA D.O.T. STANDARD SPECIFICATIONS.
- 3.) SILT FENCE SHALL BE CLEANED OUT WHEN 1/3 OF THE SILT FENCE FACE IS COVERED WITH SEDIMENT.

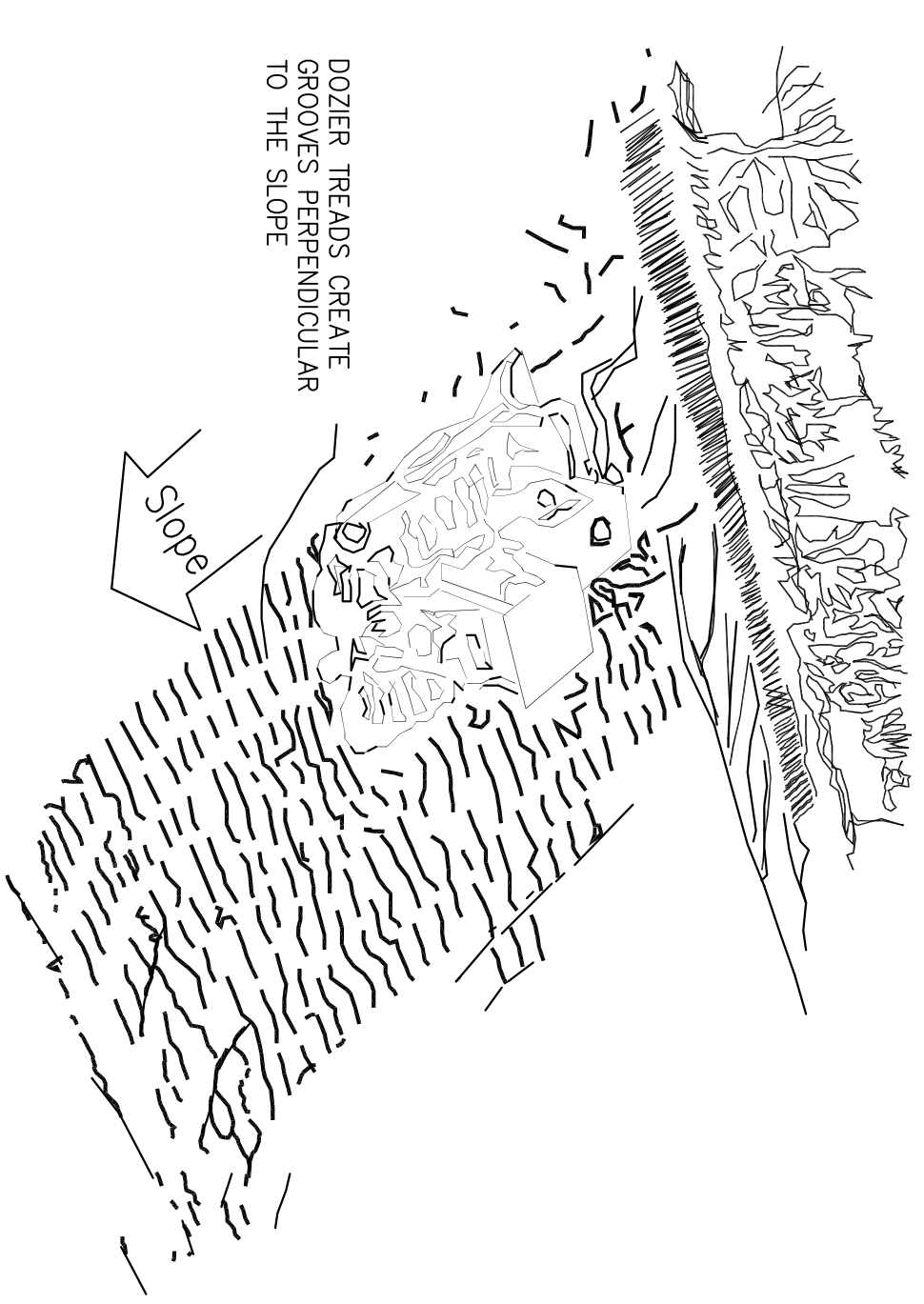

Su Surface Roughing

NTS.

REVISIONS		SCALE: AS SHOWN	PROJECT NO.
DATE	BY	DESCRIPTION	DATE:
			APRIL 2014
			DRAWING NO.
			5
			SHEET 5 OF 5

<p>NewFields</p> <p>TWO MIDTOWN PLAZA, SUITE 2000 1349 WEST PEACHTREE STREET ATLANTA, GEORGIA 30308</p>	<p>LAKE ALICE DAM BREACH REMEDIATION</p> <p>PHASE 1 WEIR INSTALLATION AND LAKE BED STABILIZATION DAM DEMOLITION EROSION CONTROL DETAILS</p>
--	---